

HOLES SHOWN REPRESENT THE 6 HOLES WHICH SECURE THE GEARBOXES.
PLEASE IDENTIFY AND MARK THESE HOLES CAREFULLY.

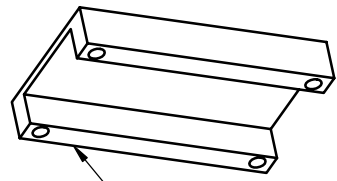

—OLDER STYLE KING TIGER BRACE. USED FOR ONLY TAMIYA SUSPENSION.

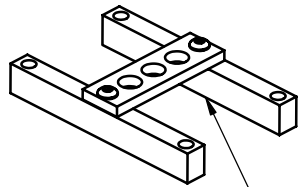

TIGER 1 AND THREE-PIECE KING TIGER BRACE.
BE SURE TO USE THREADLOCK ON SCREWS.

3mm FASTENER

—PLATE

—CROSS BRACE

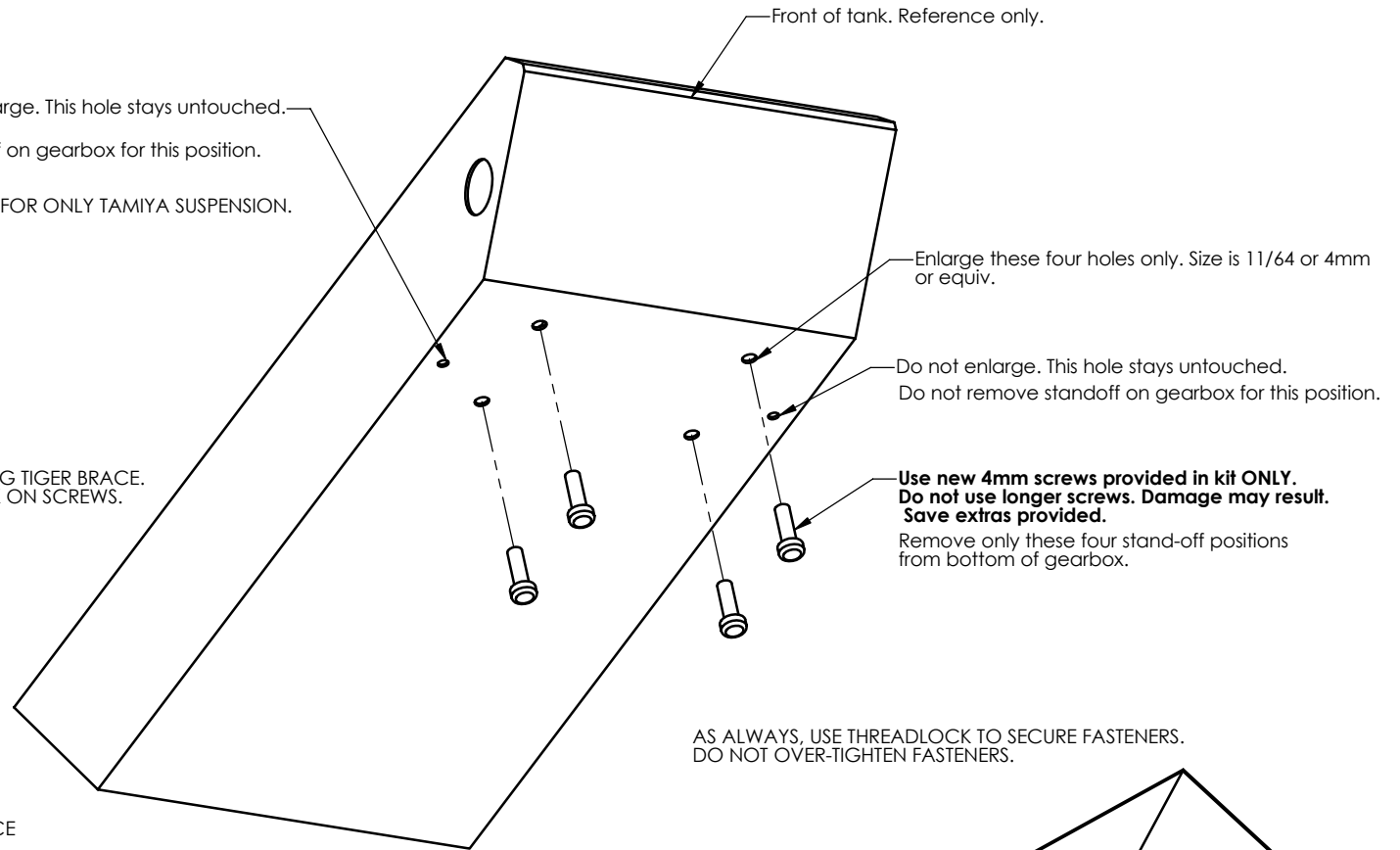
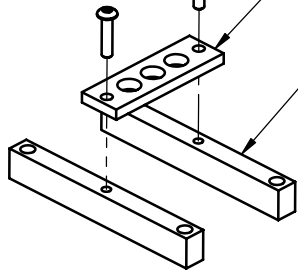

KIT IS FOR: TIGER 1 KING TIGER

KING TIGER HAS TALLER, WIDER BRACE THAN TIGER 1

BRACE FITTED IN HULL

DETAILS NOT SHOWN FOR CLARITY

